

# Sealed Deep Groove Ball Bearings

NACHI

## NSE Seal

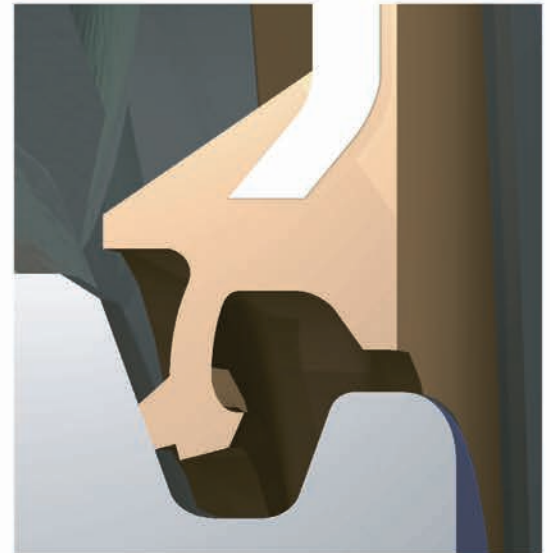

- Triple Seal Lips
- U-Shape Seal Groove
- Breathing Mechanism \*  
(on seal O.D.)

### Advanced Seal Design Provides Excellent Protection and Smooth Operation

*The combination of a unique lip design and seal groove provides a labyrinth and steady seal contact.*

*Breathing mechanism avoids torque increases caused by internal pressure variation due to changes in operating temperatures.*

*NSE seals allow NACHI bearings to have constant smooth operation and long service life.*

- Superior in Sealing Out Dust, Dirt, and Contamination
- Superb Grease Retention
- Light Torque

### The Best Components Yield the Greatest Bearing Performance

*Rings and balls made of select material have superbly controlled accuracy such as roundness, contour, surface finish, and hardness to provide quieter operation, reduced vibration levels, and long life.*

*Rivet-type pressed steel cages for strength and durability.*

*High-performance grease for long life and low noise.*

Note : \* Non-breather type seals are available for applications in severe water contact environments.

# Comparison Test Results

Nachi vs. Other Brands

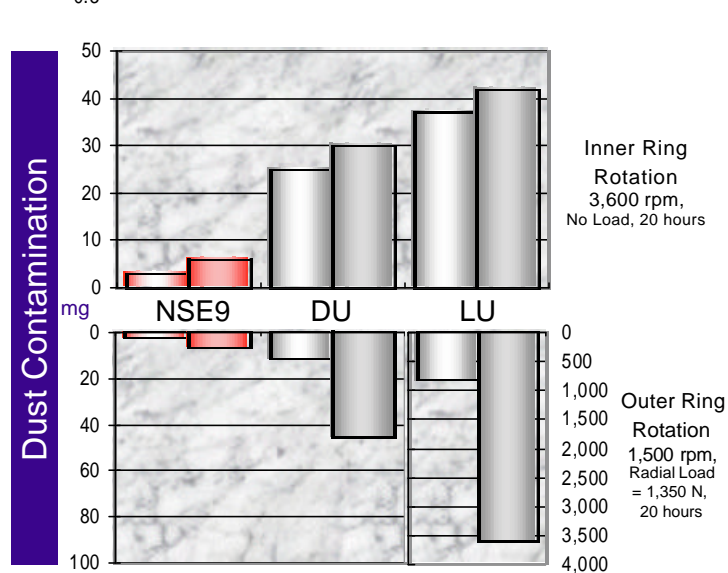
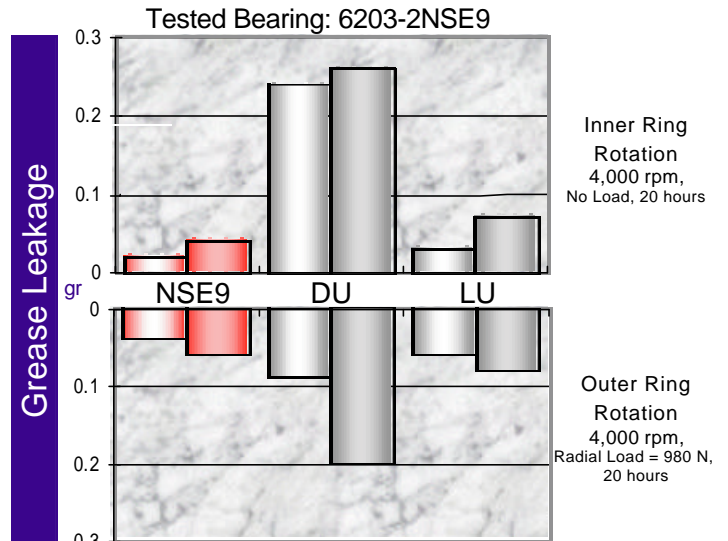
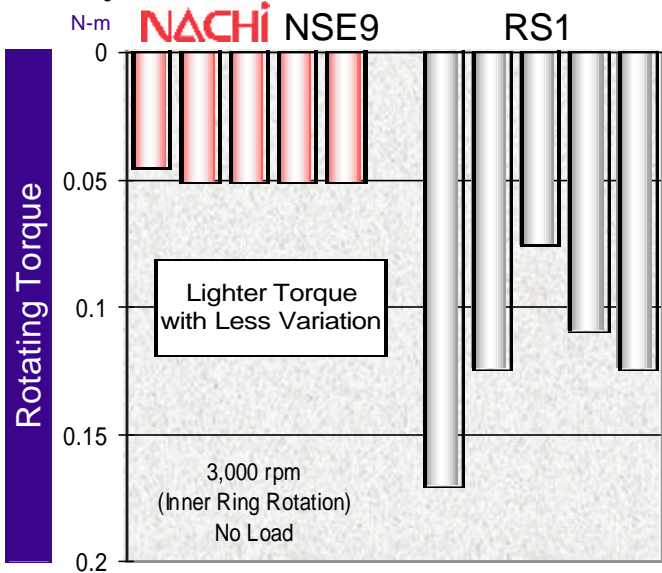
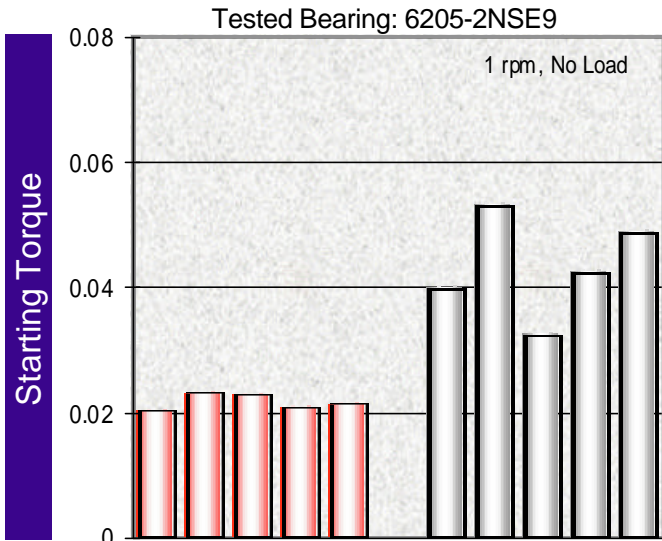

With **NACHI NSE9** Sealed Bearings, **more than 20W of energy can be saved** per bearing at 3,000 rpm.

**NACHI NSE9** Seals showed the best performance for retaining grease and avoiding the entrance of dust in these conditions.

## Offices

**NACHI AMERICA, INC.**  
Corporate Headquarters  
715 Pushville Road  
Greenwood, IN 46143  
Phone: 317-530-1001  
Fax: 317-530-1011

**WEST COAST OFFICE**  
12652 Alondra Boulevard  
Cerritos, CA 90703  
Phone: 800-548-3903  
Fax: 562-802-2455

**BEARING DIV. HEADQUARTERS**  
715 Pushville Road  
Greenwood, IN 46143  
Phone: 317-530-1002  
Fax: 317-530-1012

**ENGINEERING LABORATORY**  
Nachi Technical Center  
715 Pushville Road  
Greenwood, IN 46143  
Phone: 317-530-1008  
Fax: 317-530-1012

